

Other versions on request.

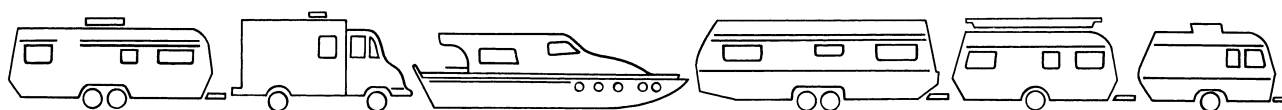



ProTOP plug
with screw terminals,
cable gland and sealing,
strain relief and protection
against kinking, enclosure with
thread lock and safety slide
16A, 3p, 230V

▲ IP 44

Part no. 148



**Angled plug
with nickel plated contacts,**
with grommet
16A, 3p, 230V

▲ IP 44

Part no. 1411



**Panel mounted receptacle
with TwinCONTACT**
screwless spring terminal,
suitable for through wiring,
straight
flange: 55 x 55 mm
fixing hole spacing: 45 x 45 mm
16A, 3p, 230V

▲ IP 44

Part no. 1619



**Panel mounted receptacle
with TwinCONTACT**
screwless spring terminal,
suitable for through wiring,
straight
flange: 62 x 62 mm
fixing hole spacing: 47 x 47 mm
16A, 3p, 230V

▲ IP 44

Part no. 1350



**Panel mounted receptacle
with TwinCONTACT**
screwless spring terminal,
suitable for through wiring,
20° inclination
flange: 73.5 x 64 mm
fixing hole spacing: 60 x 52 mm
16A, 3p, 230V

▲ IP 44

Part no. 1632



**Panel mounted receptacle
with TwinCONTACT**
screwless spring terminal,
suitable for through wiring,
straight
flange: 75 x 75 mm
fixing hole spacing: 60 x 60 mm
16A, 3p, 230V

▲ IP 44

Part no. 1668



Panel mounted receptacle
equipped with an eyelet for
a padlock, 20° inclination,
flange: 68 x 62 mm
fixing hole spacing: 47 x 47 mm
16A, 3p, 230V

▲ IP 44

Part no. 851



Plug with eyelet
16A, 3p, 230V

▲ IP 44

Part no. 852

(matching panel mounted
receptacle 851 on the left)



**Receptacle
with TwinCONTACT**
screwless spring terminal,
external fixing,
cable entry from top
16A, 3p, 230V

▲ IP 44

Part no. 1341



Adapter cable
3-core rubber sheathed
cable 1.5 m long
with CEE connector
16A, 3p, 230V
and SCHUKO® plug
16A, 230V

Part no. 8004



Adapter cable
3-core rubber sheathed
cable 1.5 m long
with SCHUKO® connector
16A, 230V
and CEE plug
16A, 3p, 230V

Part no. 8005

MENNEKES AMAXX® receptacle combinations for camp sites

pre-wired for installation. Enclosure and insert made of **AMAPLAST**. Other variations on request!

Protection type  IP 44



AMAXX® receptacle combination

Enclosure size: 260 x 225 mm

black case, upper part electric grey RAL 7035,
hinged to the side,
fusing under a transparent cover

Fitted with:

3 CEE receptacles 16A, 3p, 230V (with eyelet)

3 RCD's  25A, 2p, $I_{\Delta N} = 0.03A$

3 MCB's 16A, 1p, B

Cable entry:

2 M 32 at top (on the left open, on the right closed)

2 M 32 at bottom (closed)

additionally:

2 M 20 at top (closed)

2 M 20 at bottom (closed)

Connection:

for 1 cable up to 5 x 10 mm²

Part no. 920031

Part no. 920031SI *



AMAXX® receptacle combination

Enclosure size: 520 x 225 mm

black case, upper part electric grey RAL 7035,
hinged to the side,
fusing under a transparent cover

Fitted with:

6 CEE receptacles 16A, 3p, 230V (with eyelet)

6 RCD's  25A, 2p, $I_{\Delta N} = 0.03A$

6 MCB's 16A, 1p, B

Cable entry:

2 M 40 at top (on the left open, on the right closed)

2 M 40 at bottom (closed)

additionally:

2 M 20 at top (closed)

2 M 20 at bottom (closed)

Connection:

for 2 cables up to 5 x 25 mm²

Part no. 940011

Part no. 940011SI *

* SI = Upper part are silver (special colour)

MENNEKES AMAXX® receptacle combinations for camp sites already comply to the standard and regulations which came into force 01.07.2007 according to DIN VDE 0100-708:2006-02 and DIN VDE 0100-754:2006-02.

MENNEKES stainless steel CombiTOWER® and weather shields for wall mounting or with column

made from stainless steel (material 1.4301), suitable for outdoor installation

Outdoor electric appliances, e.g. on camp sites, may be exposed to unfavourable climatic conditions and UV radiance. Weather shields provide the protection that is needed.

The ideal energy filling station for camp sites.

Matches combinations with receptacles 16A to 63A.



Our modular system of weather shields and columns enables individual combination of installations fixed on the wall and on the ground.

For more information see chapter 9.



CombiTOWER®
stainless steel
with removable cover,
and front plate,
painted **signal yellow** (RAL 1003),
dimensions (H x W x D):
1043 x 254,5 x 250 mm,
1043 x 254 x 415 mm (with door)
matching for the AMAXX®
receptacle combinations 920031
and 940011 on the left
or similar

Part no. 15679

Part no. 15681 (with door)

High safety due to signal
yellow colour. Special RAL
colours available on request.



CombiTOWER®
stainless steel
with removable cover,
and front plate,
stainless steel finish,
dimensions (H x W x D):
1043 x 254,5 x 250 mm,
1043 x 254 x 415 mm (with door)
matching for the AMAXX®
receptacle combinations 920031
and 940011 on the left
or similar

Part no. 15678

Part no. 15680 (with door)



Weather shield
made from stainless steel
(material 1.4301)
dimensions (H x W x D):
496,5 x 254 x 250 mm
matching for the AMAXX®
receptacle combination
920031 or similar

Part no. 15682



Weather shield
made from stainless steel
(material 1.4301)
dimensions (H x W x D):
758 x 254 x 280 mm
matching for the AMAXX®
receptacle combination
940011 or similar

Part no. 15683



Column
from stainless steel
(material 1.4301)
Surface: stainless steel,
bright finish
(basic column for the two
shields shown on the left),
height approx. 1300 mm

Part no. 15530



■ Plugs and sockets, 200A up to 400A

**Receptacles,
panel mounted
receptacles,
200A up to 400A,
IP 67**

Page 296 and 297



**Plugs,
inlets and
panel mounted inlets,
200A up to 400A,
IP 67**

Page 298 and 299



**Connectors,
200A up to 400A,
IP 67**

Page 300 and 301



**Receptacles,
switched and
interlocked,
200A up to 400A,
IP 55**

Page 302 and 303



**Protective caps
for plugs and inlets,
200A up to 400A,
Page 300 and 301**



■ Plugs and sockets, 200A up to 400A

Heavy duty versions for industry.



The heavy duty range supplements the plugs and sockets currently covered by EN 60309-2, making available rated currents of 200A, 250A and 400A and rated voltages of up to 1000V. Their design is based on the following standards: IEC 309-1, EN 60309-1, DIN VDE 0623, part 1.

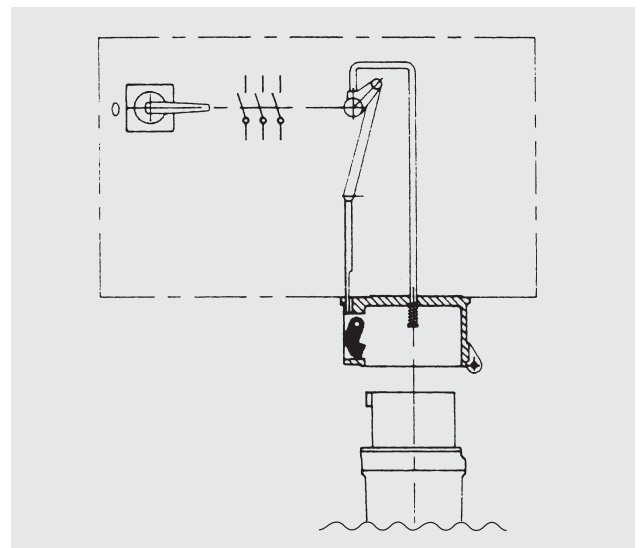

Mechanical lock.

For mobile consumers of rated current > 125A we have included a heavy duty range with 200A, 250A and 400A in our programme. This can be supplied for rated voltages of 230V to 1000V and seawater resistant.

Permissible rated current depending on the conductor cross section.

Rated dimension	Rated current I_n	Flexible conductors with single or multiple strands
200A	200A	70 mm ²
	250A	150 mm ²
250A	250A	120 mm ²
	315A	150 mm ²
400A	400A	185 mm ²
	450A	240 mm ²

The heavy duty range is suitable for use in very harsh conditions, e.g. building sites:

- drilling rigs
- tunnel construction
- gravel pits
- strip mining
- container terminals and crane connections in harbours
- for versatile power supply at large-scale indoor and outdoor events
- power supply to market places
- airports
- quarries



Testing of these combinations demonstrated that these plugs, connectors and receptacles may be operated in mines at a rated voltage of 1000V.

Shock hazard protected using contact covers.

Contact bushings on receptacles and connectors are fitted with covers which positively prevent getting into contact with live bushings. Shock hazard protected in accordance with IEC 309-1/ EN 60309-1.

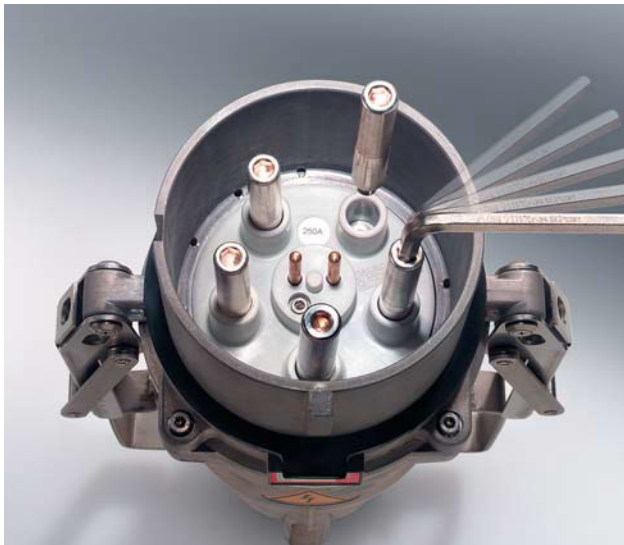

Surface protection for contacts.

Contacts 200A up to 400A are protected against corrosive atmosphere by silver plating. Contacts (250A and 400A) are accessible from the front side so that there is no need to undo the connection cable when exchanging damaged parts.



Connection terminals in plugs and sockets 200A for conductor cross sections of 70 to 150 mm², 250A and 400A for conductor cross sections of 70 to 185 mm² or with flexible conductors, and 70 to 240 mm² with single or multiple strand conductors.

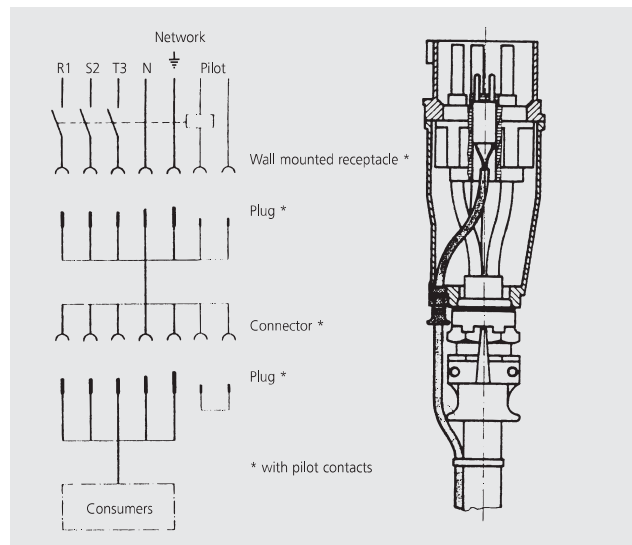

Plugs, connectors, inlets and wall mounted receptacles are supplied with flared bushings for cables of diameter 45 to 65 mm. The outside cable grip facilitates connection.

Two pilot contacts are a standard fitting in all plugs and sockets. The pilot contacts lag when the plug is inserted and lead when it is withdrawn. If required, plugs and sockets can be electrically interlocked.



Design based on IEC 309-1, EN 60309-1, DIN VDE 0623 part 1.

Other voltages and frequencies as well as larger cable entries available on request.

Seawater resistant products are available on request.

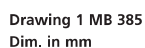

external fixing,
cable entry at top,
with cable gland

Product group 1350, type 75226 shown.

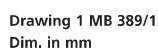

external fixing,
cable entry at top,
with cable gland

Product group 1350, type 75111 shown.

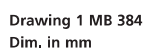

Product group 1346, type 75246 shown.



Product group 1346, type 75131 shown.

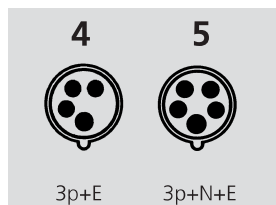

230V
50 a. 60 Hz

400V
50 a. 60 Hz

500V
50 a. 60 Hz

690V
50 a. 60 Hz

1000V
50 a. 60 Hz

4-pole 5-pole
9h 9h

4-pole 5-pole
6h 6h

4-pole 5-pole
7h 7h

4-pole 5-pole
5h 5h

4-pole 5-pole
1h 1h

Std. Pack.

Weight

Part numbers

Qty. g/each

200	4	75220	75221	75222	75223	75224	1	5580
200	5	75225	75226	75227	75228	75229	1	5780



Pilot cables

If required, pilot cables can be introduced separately into plugs/enclosures, please add „PK“ to the part number.

250	4	75020	75021	75022	75023	75024	1	10510
250	5	75110	75111	75112	75113	75114	1	11020
400	4	75025	75026	75027	75028	75029	1	10510
400	5	75115	75116	75117	75118	75119	1	11020



200	4	75240	75241	75242	75243	75244	1	3200
200	5	75245	75246	75247	75248	75249	1	3450



250	4	75040	75041	75042	75043	75044	1	6800
250	5	75130	75131	75132	75133	75134	1	7300
400	4	75045	75046	75047	75048	75049	1	6800
400	5	75135	75136	75137	75138	75139	1	7300



Design based on IEC 309-1, EN 60309-1, DIN VDE 0623 part 1.

Other voltages and frequencies as well as larger cable entries available on request.

Seawater resistant products are available on request.

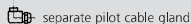

Dim. in mm

with cable gland

Product group 2313, type75206 shown.

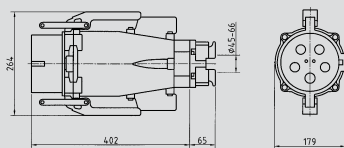

Dim. in mm

with cable gland

Product group 2313, type 75091 shown.

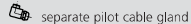

Dim. in mm

with cable gland

Product group 2348, type 75256 shown.

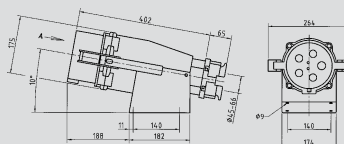

Dim. in mm

with cable gland

Product group 2348, type 75173 shown.

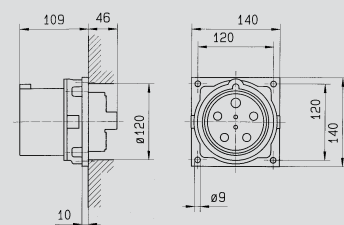

Dim. in mm

Panel: treated and nontreated firms

Product group 2350, type 75261 shown.

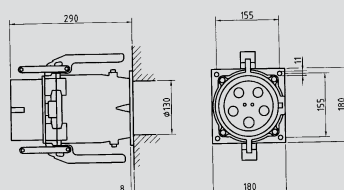

Dim. in mm

Future research needs

Product group 2350, type 75295 shown.

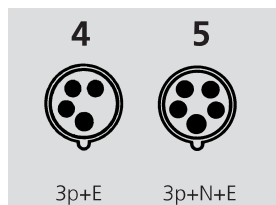

230V
50 a. 60 Hz

400V
50 a. 60 Hz

500V
50 a. 60 Hz

690V
50 a. 60 Hz

1000V
50 a. 60 Hz

4-pole 5-pole
9h 9h

4-pole 5-pole
6h 6h

4-pole 5-pole
7h 7h

4-pole 5-pole
5h 5h

4-pole 5-pole
1h 1h

Std. Pack.

Weight

Part numbers

Qty. g/each



200	4	75200	75201	75202	75203	75204	1	3000
200	5	75205	75206	75207	75208	75274	1	3200

Pilot cables

If required, pilot cables can be introduced separately into plugs/enclosures, please add „PK“ to the part number.



250	4	75000	75001	75002	75003	75004	1	8290
250	5	75090	75091	75092	75093	75094	1	8610
400	4	75005	75006	75007	75008	75009	1	8290
400	5	75095	75096	75097	75098	75099	1	8610



200	4	75250	75251	75252	75253	75254	1	4780
200	5	75255	75256	75257	75258	75259	1	4980

Pilot cables

If required, pilot cables can be introduced separately into plugs/enclosures, please add „PK“ to the part number.



250	4		75172	75373	75374		1	9660
250	5		75173	75381	75382		1	9980
400	4		75389	75390	75391		1	9660
400	5		75398	75399	75400		1	9980



200	4	75260	75261	75262	75263	75264	1	2200
200	5	75265	75266	75267	75268	75269	1	2400



250	4	75283	75284	75285	75170		1	8100
250	5	75286	75287	75288	75289		1	8600
400	4	75290	75291	75292	75293		1	8100
400	5	75294	75295	75296	75297		1	8600

Connectors, protective caps





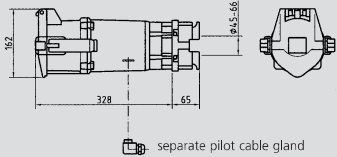
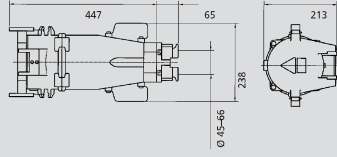
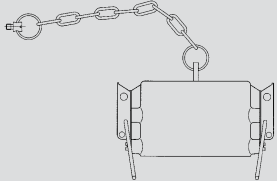
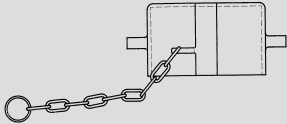

Design based on IEC 309-1, EN 60309-1, DIN VDE 0623 part 1.

Contact carrier made of creep resistant plastic, enclosure made of aluminium and/or plastic.

Other voltages and frequencies as well as larger cable entries available on request.

Seawater resistant products are available on request.

 <p>separate pilot cable gland</p>	<p>Drawing 3 MB 53 Dim. in mm</p>	<p>Connectors with cable gland</p> <p>☼☼ IP 67 Product group 3313, type 75216 shown.</p>
	<p>Drawing 3 MB 54/1 Dim. in mm</p>	<p>Connectors with cable gland</p> <p>☼☼ IP 67 Product group 3313, type 75101 shown.</p>
	<p>Drawing 2 MB 205</p>	<p>Protective caps for plug and inlet</p> <p>Product group 8326, type 75280 shown.</p>
	<p>Drawing 2 MB 201</p>	<p>Protective caps for plug and inlet</p> <p>Product group 8326, type 75160 shown.</p>

		<div>4</div>  <div>3p+E</div>		<div>5</div>  <div>3p+N+E</div>				<div>230V</div> <div>50 a. 60 Hz</div>		<div>400V</div> <div>50 a. 60 Hz</div>		<div>500V</div> <div>50 a. 60 Hz</div>		<div>690V</div> <div>50 a. 60 Hz</div>		<div>1000V</div> <div>50 a. 60 Hz</div>		Std. Pack.	Weight	
		Amp.	Poles	Part numbers				4-pole 9h	5-pole 9h	4-pole 6h	5-pole 6h	4-pole 7h	5-pole 7h	4-pole 5h	5-pole 5h	4-pole 1h	5-pole 1h			
		Qty.		g/each																
	200	4		75210	75211	75212	75213	75214	1	3730										
	200	5		75215	75216	75217	75218	75219	1	3980										
		<div>Pilot cables</div> <div>If required, pilot cables can be introduced separately into plugs/enclosures, please add „PK“ to the part number.</div>																		
	250	4		75010	75011	75012	75013	75014	1	9160										
	250	5		75100	75101	75102	75103	75104	1	9670										
	400	4		75015	75016	75017	75018	75019	1	9160										
	400	5		75105	75106	75107	75108	75109	1	9670										
	for 200A			75280					1	1200										
	for 250A			75160					1	1200										
	for 400A			75160					1	1200										

Receptacles, switched and interlocked

Design based on IEC 309-1, EN 60309-1, DIN VDE 0623 part 1.

Contact carrier made of creep resistant plastic, enclosure made of sheet steel, painted in RAL 1021.

Other voltages and frequencies as well as larger cable entries available on request.

Enclosures made of plastic or stainless steel on request.

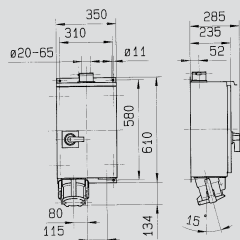

Drawing 1 MB 386
Dim. in mm

Receptacles

switched,
with mechanical interlock,
with cable entry bushing for
cables of up to 65 mm at top
and blind flange at bottom

IP 55

Product group 1374, type 75236.

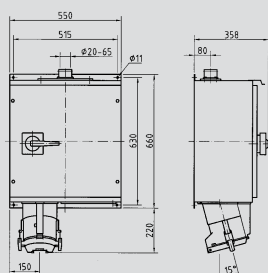

Drawing 1 MB 403/2
Dim. in mm

Receptacles

switched,
with mechanical interlock,
with cable entry bushing for
cables of up to 65 mm at top
and blind flange at bottom

IP 55

Product group 1374, type 75121.

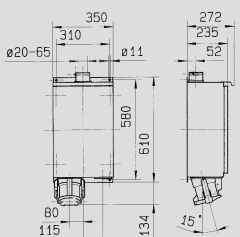

Drawing 1 MB 387
Dim. in mm

Receptacles

electrically interlocked,
with contactor,
with cable entry bushing for
cables of up to 65 mm at top
and blind flange at bottom

IP 55

Product group 1378, type 75276.

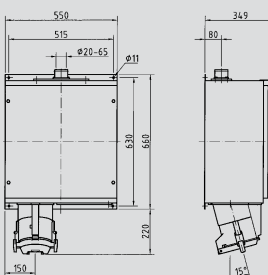

Drawing 1 MB 404/2
Dim. in mm

Receptacles

electrically interlocked,
with contactor,
with cable entry bushing for
cables of up to 65 mm at top
and blind flange at bottom

IP 55

Product group 1378, type 75174.

**Receptacles, switched
and interlocked, 200A,
250A, 400A, either 4p
or 5p, are available in
seawater resistant
design on request.**

		<div>4</div> 		<div>5</div> 				<div>230V</div> <div>50 a. 60 Hz</div>		<div>400V</div> <div>50 a. 60 Hz</div>		<div>500V</div> <div>50 a. 60 Hz</div>		<div>690V</div> <div>50 a. 60 Hz</div>		<div>1000V</div> <div>50 a. 60 Hz</div>															
		Amp.	Poles					4-pole 9h		5-pole 9h		4-pole 6h		5-pole 6h		4-pole 7h		5-pole 7h		4-pole 5h		5-pole 5h		4-pole 1h		5-pole 1h		Std. Pack.	Weight		
		Part numbers																												Qty.	g/each
	200	4						75230		75231		75232		75233		75234												1	25100		
	200	5						75235		75236		75237		75238		75279												1	25300		
	250	4						75030		75031		75032		75033		75034												1	45000		
	250	5						75120		75121		75122		75123		75124												1	46500		
	400	4						75035		75036		75037		75038		75039												1	43900		
	400	5						75125		75126		75127		75128		75129												1	45400		
	200	4						75270		75271		75272		75273														1	25100		
	200	5						75275		75276		75277		75278														1	25300		
	250	4						75436		75437		75438		75439														1	45600		
	250	5						75440		75441		75442		75443														1	47100		
	400	4						75444		75174		75445		75446														1	51000		
	400	5						75447		75448		75449		75450														1	52500		

Entries for other cable diameters (> 65mm) and other accessories are also available.

Please contact us.