



■ Cable connection boxes, hinged windows, enclosures

Cable connection boxes

AMAPLAST

Page 308 and 309

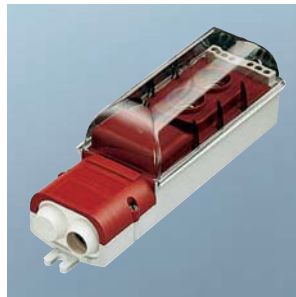

Hinged windows and accessories

Page 310 and 311



AMAPLAST enclosures

Page 312 and 313



EverGUM solid rubber enclosures, signal yellow or black

Page 314 and 315



EverGUM solid rubber enclosures, signal yellow or black

Page 314 and 315



■ Cable connection boxes, hinged windows, enclosures

Cable connection boxes for lamp posts.

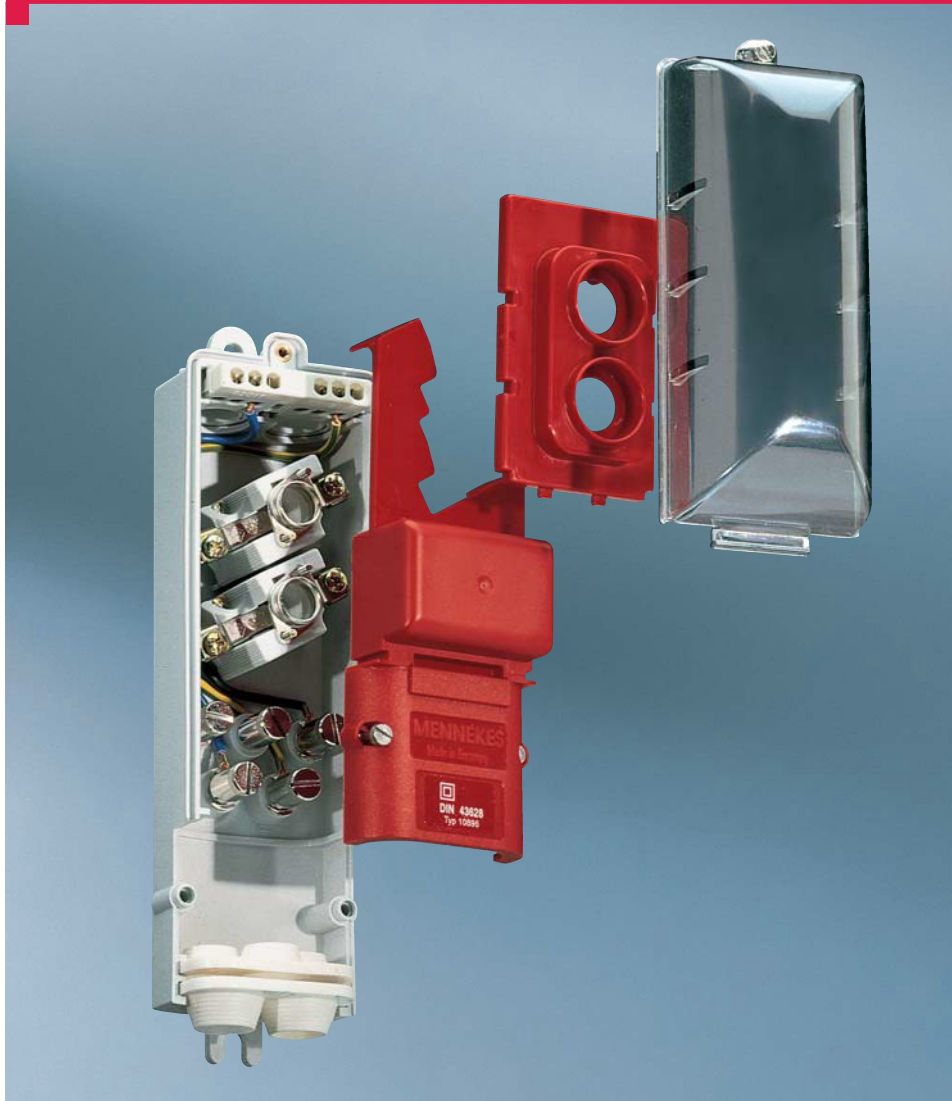

Protection  IP 44.
Dimensions in accordance
with DIN 43626.
Protection class II.

Shock hazard protected for
finger touch by a latching
cover in accordance with
BGV A3 (formerly VBG4).
Cable connection boxes
may be fitted with either
one or two fuse bases
D 01/E 14 and 5 connection
terminals rated for
 $2 \times 16\text{mm}^2$ or $3 \times 10\text{mm}^2$.
The fuse elements are
factory wired.



Suitable for installation
in lamp posts with an
internal diameter of 82mm
or more and a door
aperture of 75 x 250mm
or more.
The cable connection
boxes are generally
supplied pre-wired,
which results in a
significant reduction
of costs. The transparent
cover of the casing can
be easily removed for
access to the fuses.

AMAPLAST and EverGUM enclosures.



AMAPLAST and EverGUM enclosures are characterized by an excellent stability and the following outstanding features:

- good electrical insulation
- high mechanical strength
- wear resistance
- abrasion resistance
- dimensional stability
- self-extinguishing
- heat resistance
- high cold resistance
- ageing resistance
- seawater resistance

For more information on enclosure materials, please see the product information pages in chapters 7, 8 and 10.

Hinged windows.

Hinged windows are suitable for fitting in enclosures (e.g. MENNEKES enclosures), machines, cable ducts and switchgear cabinets.

Using angle plates and mounting rails, the hinged windows together with built-in modules can be fitted into enclosures or the doors of switchgear cabinets.



Hinged windows with or without protective cover can be supplied to fit module spacing of 2, 5, 6, 8 and 12. Optionally lockable with bracket and padlock.



MENNEKES connection boxes made of AMAPLAST

Dimensions to DIN 43628.

Protection type  IP 44.

Other versions, e.g. **4-pole** design, are available on request.

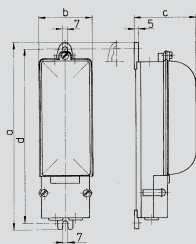

Drawing 8 MB 119

Dim. in mm	a	250
	b	72
	c	75
	d	232

Cable connection box

for lamp posts with an **internal diameter of 82 mm or more**, with smoked glass cover, with cable bushings for 1 or 2 entries of diameter 17 to 24 mm or 3 entries of diameter 15 to 19 mm, 5 sheath terminals of 2 x 16 mm², with 1 open and 1 closed M 20 gland, wired ready for connection

Product group 9812, type 10895 shown.

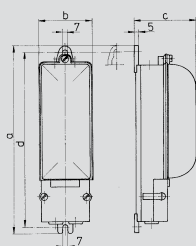

Drawing 8 MB 119

Dim. in mm	a	250
	b	72
	c	75
	d	232

Cable connection box

for lamp posts with an **internal diameter of 82 mm or more**, with smoked glass cover, with cable bushings for 1 or 2 entries of diameter 17 to 24 mm or 3 entries of diameter 15 to 19 mm, 5 sheath terminals of 2 x 16 mm², with 1 open and 1 closed M 20 gland, wired ready for connection

Product group 9812, type 10896 shown.

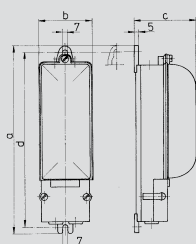

Drawing 8 MB 119

Dim. in mm	a	250
	b	72
	c	75
	d	232

Cable connection box

for lamp posts with an **internal diameter of 82 mm or more**, with smoked glass cover, with cable bushings for 1 or 2 entries of diameter 17 to 24 mm or 3 entries of diameter 15 to 19 mm, 5 sheath terminals of 2 x 16 mm², with 1 open and 1 closed M 20 gland, wired ready for connection

with fuse cartridges 10A

Product group 9812, type 10906 shown.

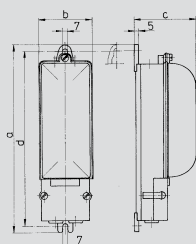

Drawing 8 MB 119





Dim. in mm	a	250
	b	72
	c	75
	d	232

Cable connection box

for lamp posts with an **internal diameter of 82 mm or more**, with smoked glass cover, with cable bushings for 1 or 2 entries of diameter 17 to 24 mm or 3 entries of diameter 15 to 19 mm, 5 sheath terminals of 2 x 16 mm², with 1 open and 1 closed M 20 gland, wired ready for connection

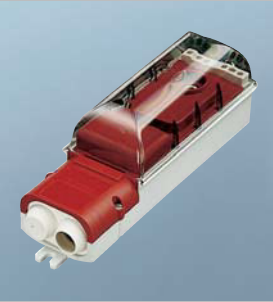
with fuse cartridges 10A

Product group 9812, type 10907 shown.

		D-type fuse sockets	Voltage up to	Part numbers	Std. Pack. Qty.	Weight g/each
	1 x D 01 (E 14)		400	10895	15	420
	2 x D 01 (E 14)		400	10896	15	463
	1 x D 01 (E 14)		400	10906	15	435
	2 x D 01 (E 14)		400	10907	15	494

MENNEKES hinged windows made of AMAPLAST and accessories

Protection types ▲ IP 44 or ▲▲ IP 67

Locking mechanism with padlock

for MENNEKES hinged windows

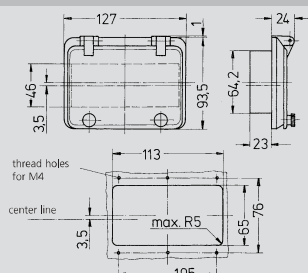

No. 40986 / Drawing 6 MB 17 / 6 modules

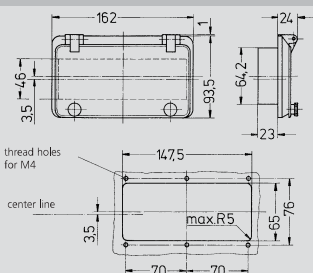

No. 40979 / Drawing 6 MB 12 / 8 modules

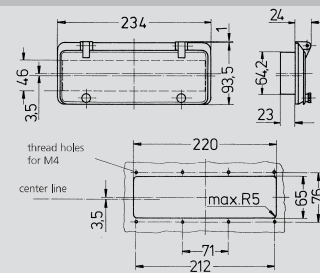

No. 40981 / Drawing 6 MB 13 / 12 modules

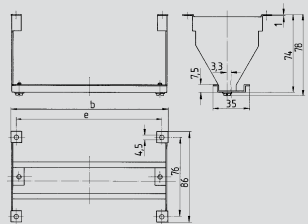

Drawing 6 MB 18

Number of spacing modules	b	e
6	115	105
8	150	140
12	222	212

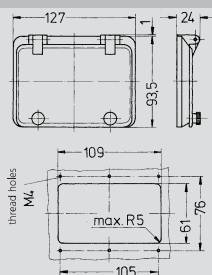

No. 40985 / Drawing 6 MB 16 / 6 modules

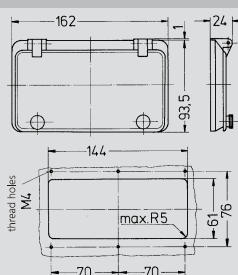

No. 40978 / Drawing 6 MB 15 / 8 modules

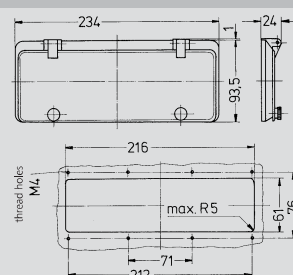

No. 40980 / Drawing 6 MB 14 / 12 modules

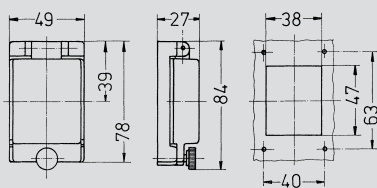

No. 40444 / Drawing 6 MB 3 / 2 modules

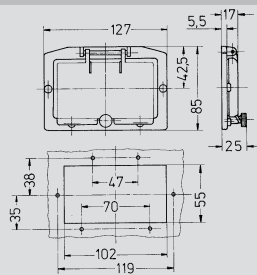

No. 40871 / Drawing 6 MB 4 / 5 modules

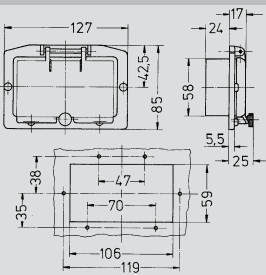

No. 40243 / Drawing 6 MB 2 / 5 modules

If required, hinged windows may be locked using a padlock as shown on the right.

		Frame colour	Window colour	Part numbers	Weight g/each
	Hinged window with protective cover , with knurled screws				
	for 6 modules	electric grey	smoked glass	40986	128
	for 8 modules	electric grey	smoked glass	40979	169
	for 12 modules	electric grey	smoked glass	40981	225
	☼ IP 67				
	Installation kit for hinged window with protective cover , for fitting modules in doors and enclosure covers				
	for 6 modules (for hinged window 40986)			41431	99
	for 8 modules (for hinged window 40979)			41432	111
	for 12 modules (for hinged window 40981)			41433	135
	Hinged window without protective cover , with knurled screws				
	for 6 modules	electric grey	smoked glass	40985	107
	for 8 modules	electric grey	smoked glass	40978	127
	for 12 modules	electric grey	smoked glass	40980	169
	☼ IP 67				
	Hinged window with knurled screws				
	for 2 modules	electric grey	smoked glass	40444	42
	without protective cover				
	for 5 modules	electric grey	smoked glass	40871	75
	without protective cover ¹⁾				
	for 5 modules	electric grey	smoked glass	40243	94
	with protective cover ¹⁾				
	⚠ IP 44 ¹⁾ without hinged window spring				
	Locking mechanism with padlock to lock hinged windows				
	Part no. 41501				
					

MENNEKES enclosures made of AMAPLAST

Protection type ▲ IP 44 or ● IP 67

For information on material properties and resistance, see chapters 7, 10 and 20.

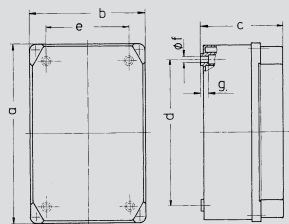

Part Numbers	10176	10178	10179	10181
Dim. in mm				
a	170	170	245	341
(a)	(158)	(158)	(230)	(320)
b	118	118	160	172
(b)	(108)	(108)	(145)	(152)
c	64	96	101	107
(c)	(55)	(85)	(85)	(95)
d	134,5	134,5	*201	272
e	103	103	*133	140
f	6,1	6,1	5,5	8,5
g.	6	6	10	6,5

The dimensions in brackets show the inner dimensions.
*Additional blind fixing holes (can be cut out), spaced 137 x 172 mm

Drawing 5 MB 8

Enclosures

made of AMAPLAST,
mounting plate made of insulating material

Part no. 10176 and 10178: ● IP 67

Part no. 10179 and 10181: ▲ IP 44

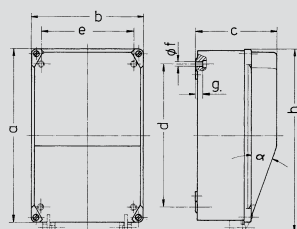

Part Numbers	10696	10757	10679	10758
Dim. in mm				
a	245	245	341	341
(a)	(230)	(230)	(320)	(320)
b	160	160	172	172
(b)	(145)	(145)	(152)	(152)
c	151	116	149	149
(c)	(137)	(102)	(135)	(135)
d	*201	*201	272	272
e	*133	*133	140	140
f	5,5	5,5	8,5	8,5
g.	10	10	6,5	6,5
h	—	25,9	—	35,5
alpha	34°	20°	34°	34°

The dimensions in brackets show the inner dimensions.
*Additional blind fixing holes (can be cut out), spaced 137 x 172 mm

Drawing 5 MB 6, 5 MB 36

Enclosures

made of AMAPLAST,
mounting plate made of insulating material

▲ IP 44

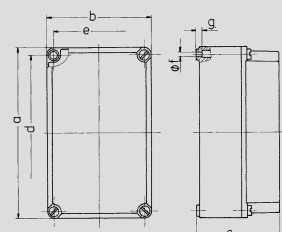

Part Numbers	10183	10185
Dim. in mm		
a	264	264
(a)	(250)	(250)
b	163	163
(b)	(150)	(150)
c	126	126
(c)	(110)	(110)
d	240	240
e	140	140
f	8,1	8,1
g.	8	8

The dimensions in brackets show the inner dimensions.

Drawing 5 MB 31

Enclosures

made of AMAPLAST,
mounting plate made of insulating material

● IP 67

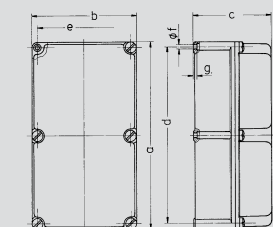

Part Numbers	10441/10442	10186/10188	10189
Dim. in mm			
a	460	460	460
(a)	(406)	(441)	(437)
b	180	260	260
(b)	(126)	(195)	(194)
c	148	150	228
(c)	(131)	(128)	(208)
d	440	434	434
e	160	234	234
f	8,1	11	11
g.	8	9.	9.

The dimensions in brackets show the inner dimensions.

Drawing 5 MB 30

Enclosures

made of AMAPLAST,
mounting plate:
Part no. 14443 made of zinc sheet
steel
Part no. 10187 made of insulating material

● IP 67

	External box dimensions		Colour	Part no.	Weight
	mm				g/each
	170 x 118 x 64	Box	electric grey	10176	335
		Baseplate		10177	50
	170 x 118 x 96	Box	electric grey	10178	383
		Baseplate		10177	50
	245 x 160 x 101	Box	electric grey	10179	660
		Baseplate		10180	80
	341 x 172 x 107	Box	electric grey	10181	920
		Baseplate		10182	110
	245 x 160 x 151	Box			
		without hinge	electric grey	10696	740
	245 x 160 x 116	with hinge	electric grey	10757	750
		Baseplate		10180	80
	341 x 172 x 149	Box			
		without hinge	electric grey	10679	1035
	341 x 172 x 149	with hinge	electric grey	10758	1045
		Baseplate		10182	110
	264 x 163 x 126	Box	electric grey	10183	975
		Baseplate		10184	125
	264 x 163 x 126	Box			
		Cover	transparent smoked glass		
		Base	electric grey	10185	975
		Baseplate		10184	125
	460 x 180 x 148	Box	electric grey	10441	2080
		Baseplate	zincd	10443	410
	460 x 180 x 148	Box			
		Cover	transparent smoked glass		
		Base	electric grey	10442	2080
		Baseplate	zincd	10443	410
	460 x 260 x 150	Box	electric grey	10186	2900
		Baseplate		10187	550
	460 x 260 x 150	Box			
		Cover	transparent smoked glass		
		Base	electric grey	10188	2900
		Baseplate		10187	550
	460 x 260 x 228	Box	electric grey	10189	3450
		Baseplate		10187	550

On request with holes for cable entries.











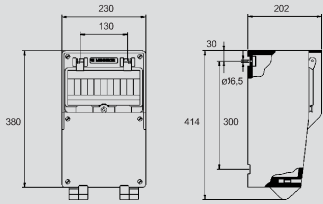

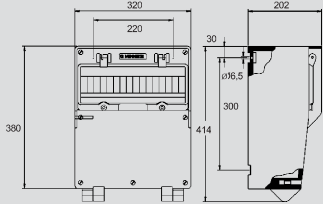
MENNEKES solid rubber enclosures EverGUM, signal yellow or black

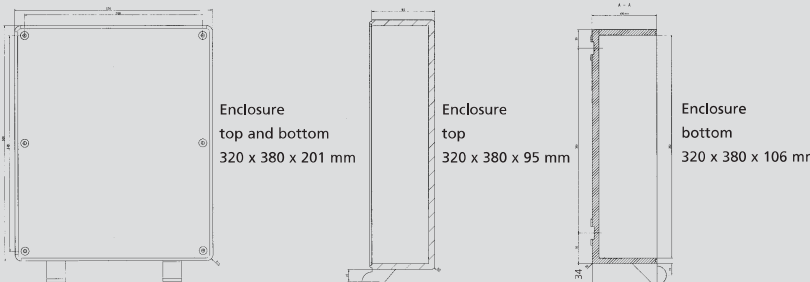
Protection type  IP 44.

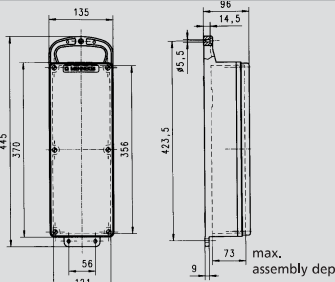
For information on material properties and resistance, see chapters 8 and 20.

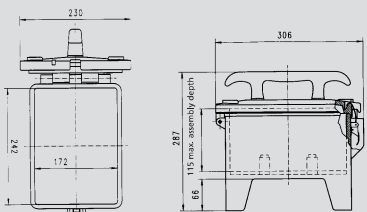
EverGUM solid rubber enclosures are also available in black or other colours.

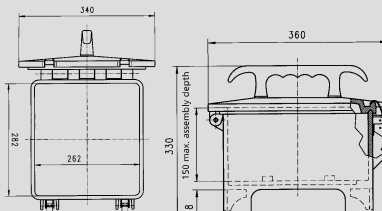
Please contact us.

	Dim. in mm	Wall mounted enclosures EverGUM with hinged cover, without holes  IP 44 Type 70060 shown.
	Dim. in mm	Wall mounted enclosures EverGUM with hinged cover, without holes  IP 44 Type 70059 shown.
		Wall mounted enclosures EverGUM with hinged cover, without holes  IP 44 Type 70850 shown.
	Drawing 5 MB 44 Dim. in mm	Wall mounted enclosures EverGUM as receptacle strips, portable, with hinged cover without holes  IP 44 Type 70062 and 70117 shown.
 View from top with open cover	Drawing 5 MB 48a Dim. in mm	Enclosures EverGUM compact solid rubber distributors, portable, stackable, with hinged cover, with stainless steel quick release, without holes  IP 44 Type 70385 shown.
 View from top with open cover	Drawing 5 MB 43 Dim. in mm	Enclosures EverGUM maxi solid rubber distributors, portable, stackable, with hinged cover, with stainless steel quick release, without holes  IP 44 Type 70061 shown.

	Components	Colour	Part no.		Std. Pack.	Weight
					Qty.	g/each
	with N+PE terminal with hinged window and DIN-rail for 12 modules	signal yellow	70060		1	6022
		black	70091		1	6022
	with N+PE terminal with hinged window and DIN-rail for 16 modules	signal yellow	70059		1	8200
		black	70090		1	8200
	with N+PE terminal	signal yellow	70850		1	
		black	7301977		1	
	with N+PE terminal	signal yellow	70062		2	
		black	70093		2	
	with hinged window and DIN-rail for 6 modules	signal yellow	70117		2	
		black	70117SW		2	
	with 1 DIN-rail for 12 modules, with N+PE terminal	signal yellow	70385		1	4950
		black	70385SW		1	4950
	with N+PE terminal	signal yellow	70061		1	7920
		black	70092			7920
	1 DIN-rail for 12 modules, without N+PE terminal	signal yellow	70061ZA		1	
	2 DIN-rails for 12 modules, with N+PE terminal	signal yellow	70061ZB		1	